

# Cautions when attaching the stand

Please note the following when using the stand.

To prevent the accidents during transport, the media stopper screws are securely tightened when packing it.

Slightly loosen the screws with a screwdriver during the installation and adjust so that the media stopper is easier to slide.

When loosening the screw too much, it may be removed. Please check that the rear end of the screw is not missing.

### When using CE6000-60 (ST0100)

[Right side of the unit]

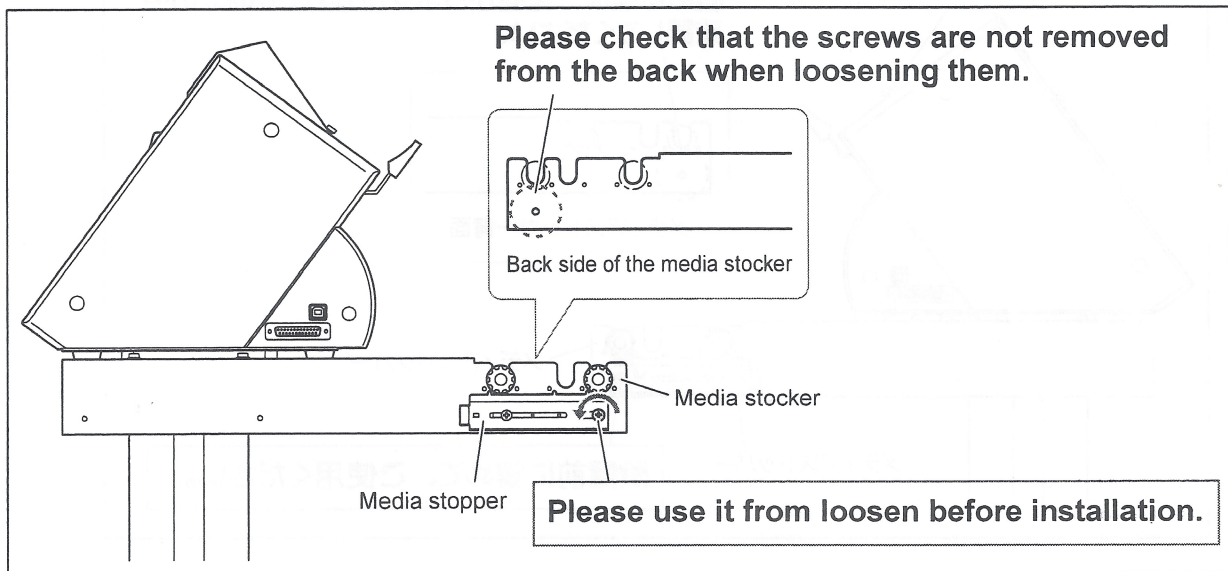

### When using CE6000-120 (ST0101)

[Right side of the unit]

